

GENERAL NOTES

- TYPE 3R ENCLOSURE. FREE STANDING. FLOOR MOUNTED. CODE GAUGE FORMED STEEL FRAME CONSTRUCTION.
- FRONT DOOR HAS A STAINLESS STEEL, PADLOCKABLE HANDLE.
- FINISH: TYPE 3R: ANSI 61 GRAY POLYESTER SEMI GLOSS ELECTROSTATIC POWDER.
TYPE 3RX (R): EXTERIOR CONSTRUCTED OF CODE GAUGE TYPE 304 STAINLESS STEEL.
TYPE 3RX (S): EXTERIOR CONSTRUCTED OF CODE GAUGE TYPE 316 STAINLESS STEEL.
- RECOMMENDED CLEARANCES:
FRONT: 38 INCHES REAR: 38 INCHES
- DESIGNED FOR FRONT & REAR ACCESS
- FOR SPECIFIED TRANSFER SWITCH, REFER TO OPERATOR'S MANUAL PROVIDED WITH UNIT.
- SECTION 1 & SECTION 1T SHIP AS 1 UNIT.
- LIFTING PLATES: SECTIONS ARE SUPPLIED WITH REMOVABLE LIFTING PLATES. INSPECT PLATES FOR DAMAGE AND TORQUE BOLTS TO 45 FT LBS BEFORE USE. REFER TO ANSI/NEMA PB 2.1 FOR PROPER HANDLING OF EQUIPMENT. AFTER INSTALLATION OF SECTION, REMOVE LIFTING PLATES. REINSTALL BOLTS INTO EXTERIOR HOLES AND TORQUE TO APPROXIMATELY 20 FT LBS.

SPECIFICATIONS

- SERVICE VOLTAGE:
SYSTEM RATING: 1000 AMPS, 1200 AMPS, 3 ϕ , 4W OR 1 ϕ , 3W.
SHORT CIRCUIT RATING SOURCE-1: 50,000 RMS SYM AMPERES @ 480V.
SHORT CIRCUIT RATING SOURCE-2: 22,000 RMS SYM AMPERES @ 480V.
THE SOURCE-2 INPUT MUST BE PROTECTED BY A REMOTE OVERCURRENT PROTECTION DEVICE AS LISTED ON THE MARKINGS ON THE TRANSFER SWITCH.
GROUND BUS- 20% RATED
- NEUTRAL BUS: 100% RATED.
- APPLICABLE LABELS: U.L. 891- SUITABLE ONLY FOR USE AS SERVICE EQUIPMENT.

TRANSFER SWITCH

- H FRAME AUTOMATIC TRANSFER SWITCH 1000A - 1200A.
- TRANSFER SWITCH RATING: 1000 AMPS, 1200 AMPS.
SHORT CIRCUIT RATING WHEN PROTECTED BY A CIRCUIT BREAKER
TIME RESPONSE, MAXIMUM 0.05 SECONDS: 50,000 RMS SYM AMPERES @ 480V.
SPECIFIC BREAKER RATING: 65,000 RMS SYM @ 480V.
- A FULL RATED NEUTRAL CONNECTION FOR EACH SOURCE AND THE LOAD IS OPTIONAL.
WHEN PROVIDED IT IS IN ONE OF THE FOLLOWING FORMATS.
A. SOLID NEUTRAL
B. SWITCHED NEUTRAL POLE
- UL 1008

TERMINATIONS 1000-1200 AMPS

- SUPPLIED WITH STANDARD MECHANICAL (SCREW TYPE) LUGS.
SOURCE 1: (4) 1/0 AWG - 600MCM PER PHASE & NEUTRAL
LOAD: (4) 1/0 AWG - 600MCM PER PHASE & NEUTRAL
SOURCE 2: (3) 1016 SERIES SINGLE POLE CAM LOCK MALE RECEPTICALS PER PHASE & NEUTRAL
GROUND: (12) 1/0 -600MCM
A. SUITABLE WIRE BENDING SPACE IS PROVIDED AS PER THE NEC
- OPTIONAL LUGS MAY BE SUPPLIED.

CIRCUIT BREAKER: ITEM 52U

- SQUARE "D" 80% RATED, TYPE 'RJF', 2500AF/1000AT OR 2500AF/1200AT STATIONARY MOUNTED, MANUALLY OPERATED, WITH LONG DELAY, SHORT DELAY, INSTANTANEOUS AND GROUND FAULT TRIP SETTINGS.
- OPTIONAL 100% RATED BREAKER MAY BE SUPPLIED.
- OPTIONAL ENERGY REDUCTION AND MAINTENANCE SETTING SYSTEM MAY BE SUPPLIED.
- U.L.489

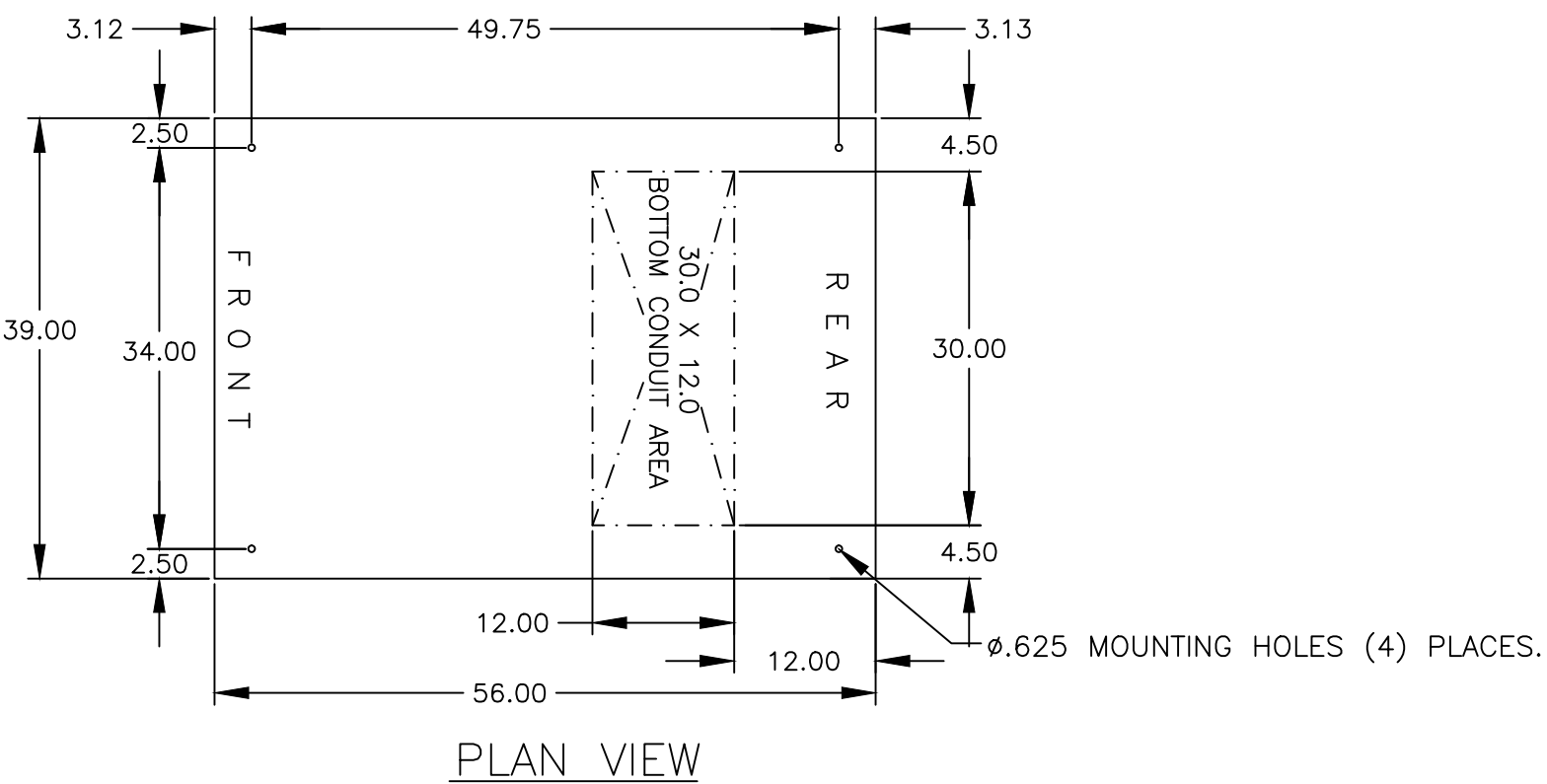
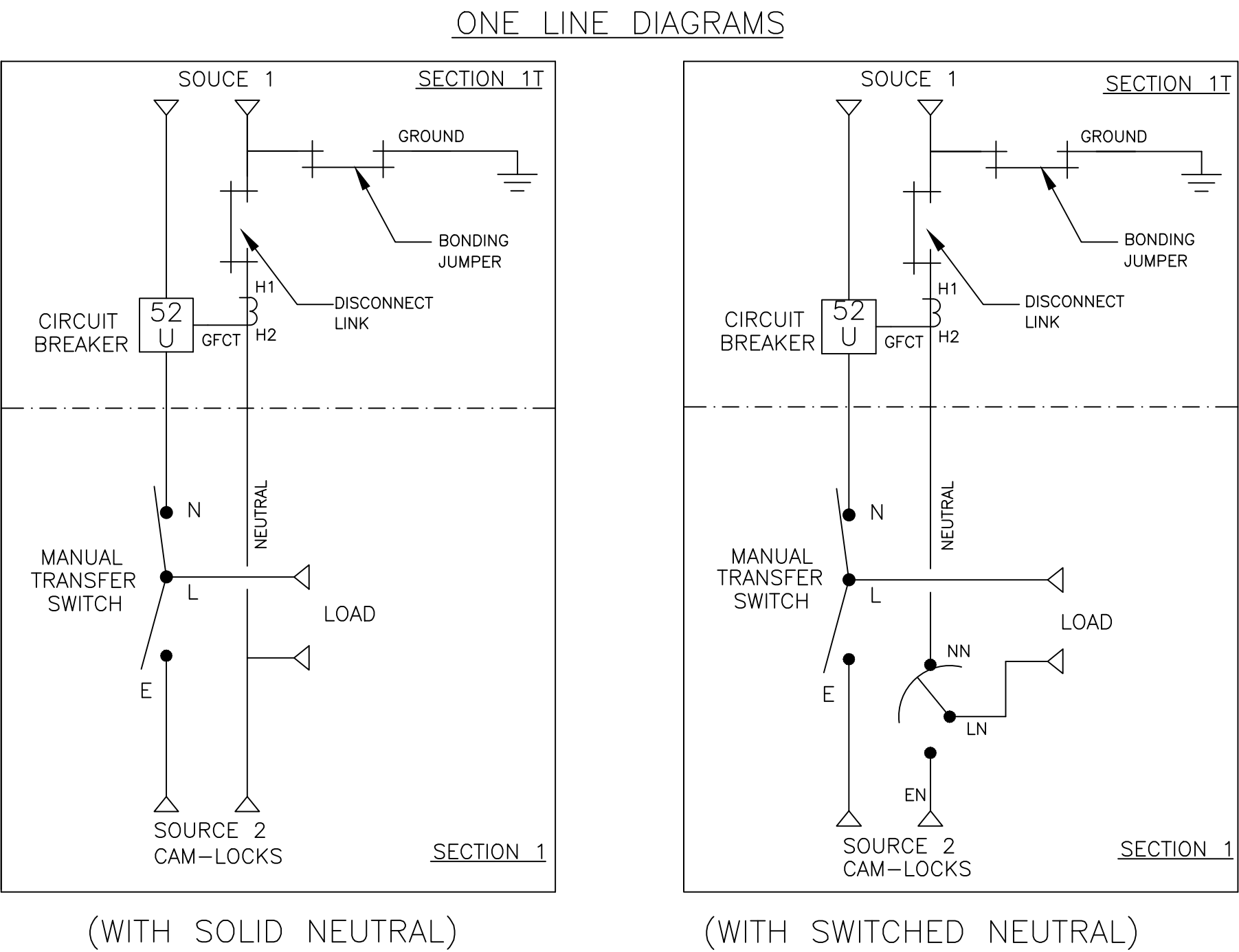
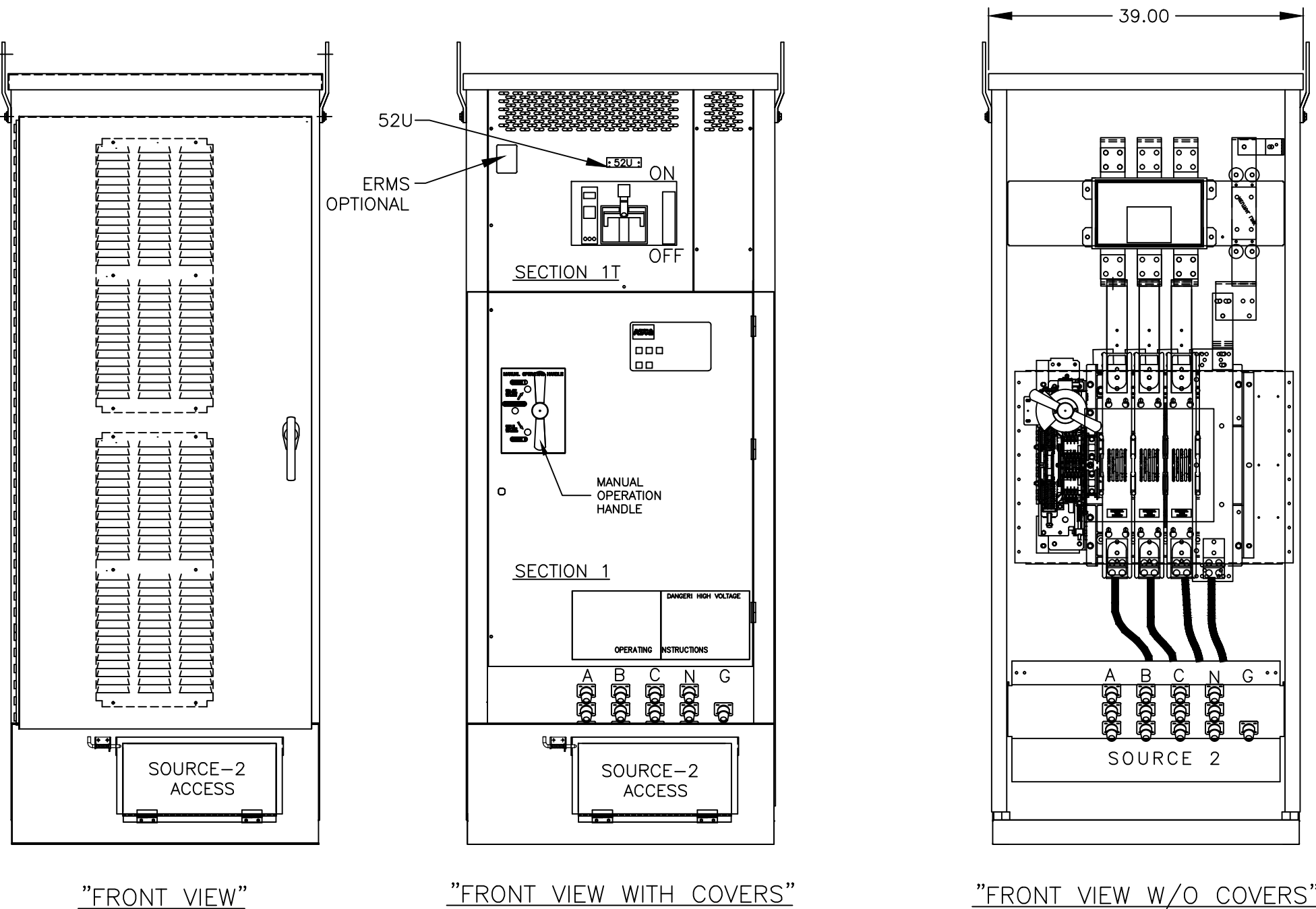

PROJECT NAME:		REV. TO SHEET	ECN NO.	BY	APP.	DATE
OUTLINE		MOUNTING				
HMUS 1000A-1200A, RJF SE BRKR ON SOURCE 1,CAMLOCKS ON SOURCE 2		THIRD ANGLE PROJECTION				
TYPE 3R/3RX, 96 X 39 X 56		COMPUTER GENERATED DRAWING				
DRAWN BY	MCH	DATE	11-26-18	MANUFACTURING TOLERANCES TO BE IN ACCORDANCE WITH ASCO PROCEDURE MP-1-003. FOR PLASTIC PARTS SEE MP-1-005	ASSEM. REF. NO.	SCALE 1/16" = 1" SIZE DS
CHECKED	RN			PROPERTY OF ASCO POWER TECHNOLOGIES, USE PERMITTED FOR OUR WORK ONLY. ALL RIGHTS OF DESIGN OR INVENTION ARE RESERVED.		DWG. NO. 977104-005
PROJECT APPROVAL				ASCO® ASCO POWER TECHNOLOGIES, L.P. FLORHAM PARK, NEW JERSEY 07932 U.S.A.		DRAWING A REV. 1
FINAL APPROVAL						ECN NO. 277065 SHEET 10F1