

REVISION HISTORY				
REV	DESCRIPTION	ECO	BY	DATE
-01	RELEASED FOR CUSTOMER INQUIRIES	N/A	NDA	1/1/2019

Small 19 Series Wall Mount

ONE-LINES AVAILABLE UPON REQUEST

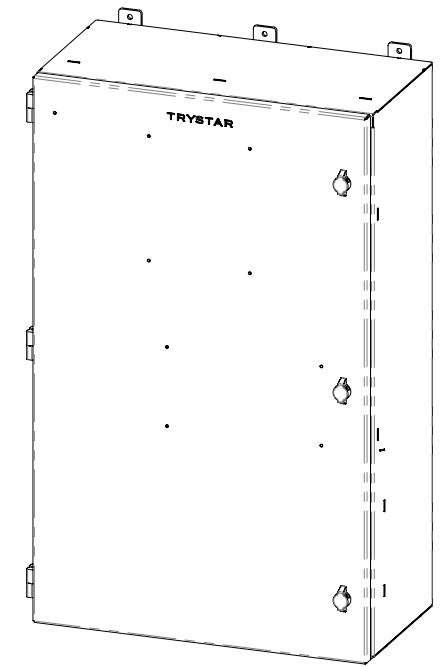
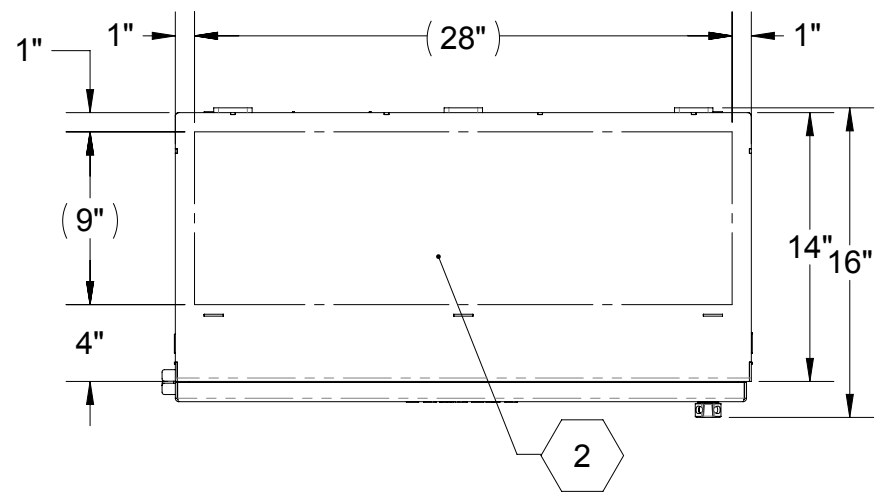

DIMETRIC VIEW CLOSED
1:16 SCALE

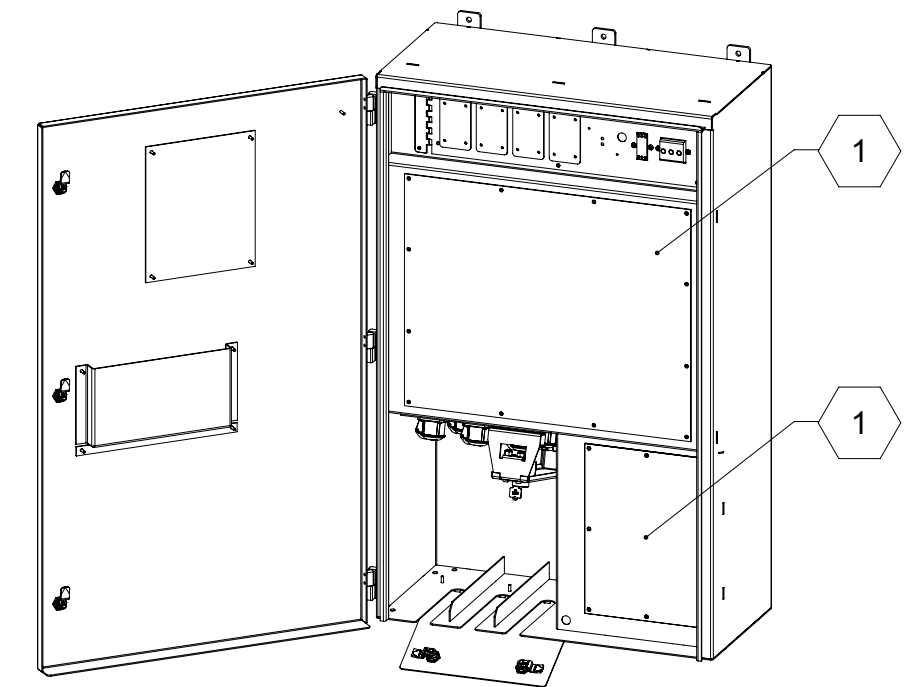
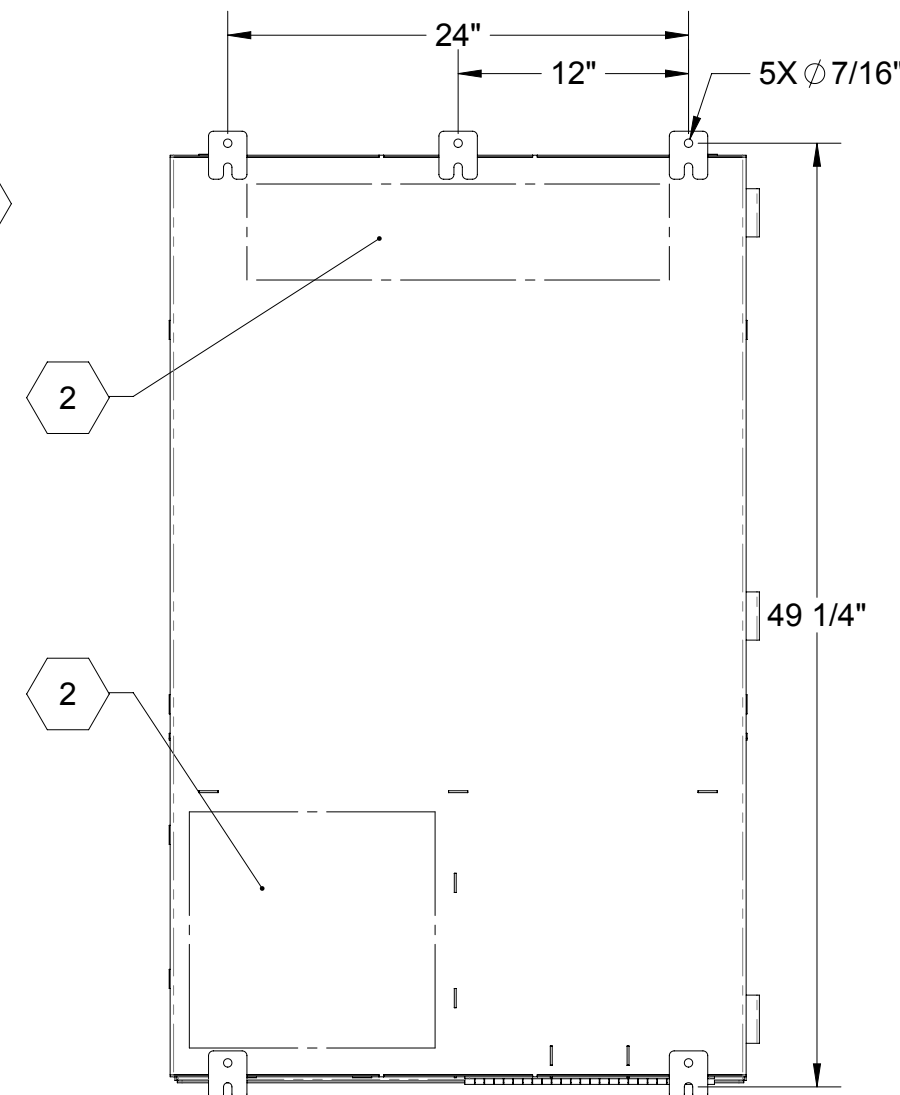
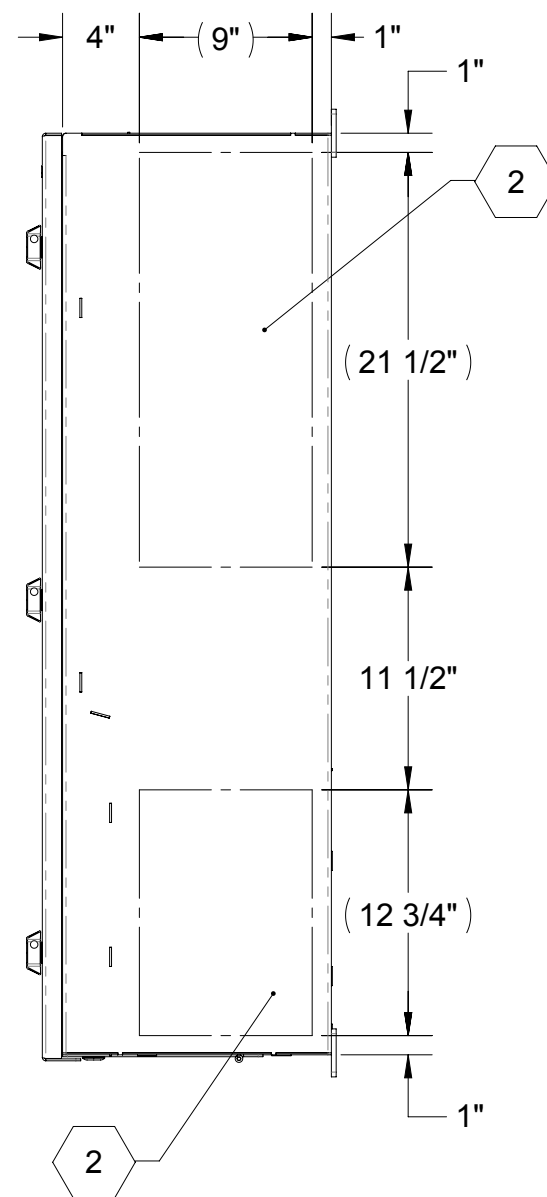
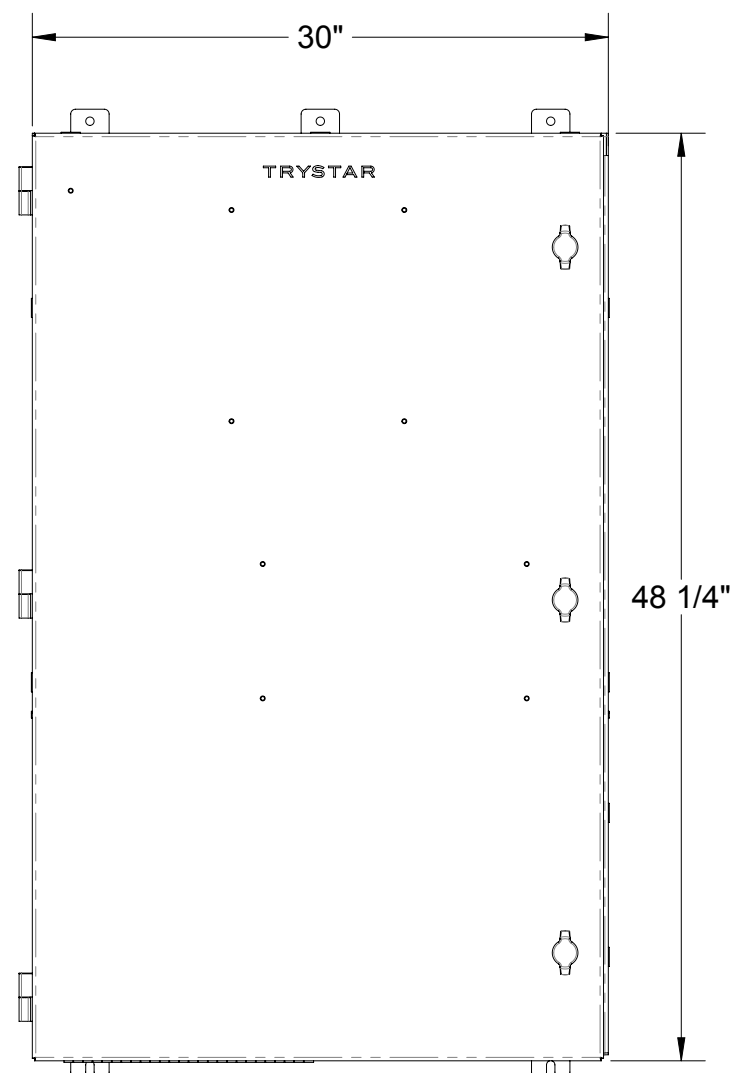
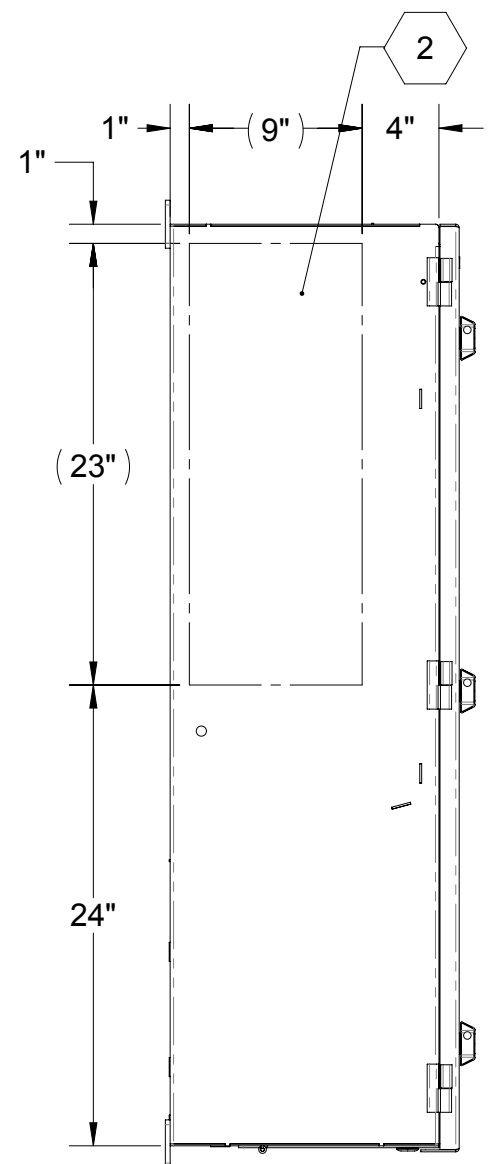

DIMETRIC VIEW OPEN
1:16 SCALE

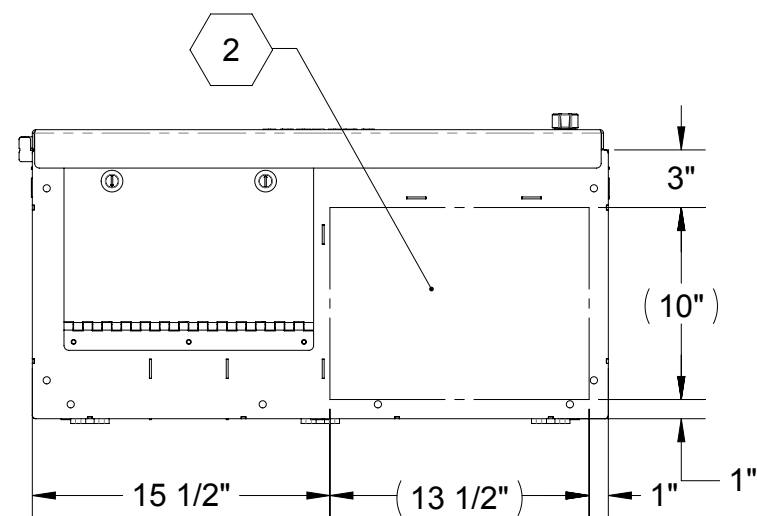

NOTES:

1. REMOVABLE ACCESS PANEL
2. CONDUIT ENTRY AREA - SIZE & LOCATION SUBJECT TO CHANGE WITH ADDITION OF FEATURES

PROPRIETARY AND CONFIDENTIAL
THE INFORMATION CONTAINED IN THIS DRAWING IS THE SOLE PROPERTY OF TRYSTAR, INC. ANY REPRODUCTION IN PART OR AS A WHOLE WITHOUT THE WRITTEN PERMISSION OF TRYSTAR, INC. IS PROHIBITED.

MATERIAL
FINISH

UNLESS OTHERWISE SPECIFIED DIM ARE IN INCHES
TOL ON ANGLE ± 1° FRACTION ± 1/16
1 PL ± 1/32 2 PL ± .015 3 PL ± .010
INTERPRET DIM AND TOL PER ASME Y14.5M-1994

THIRD ANGLE PROJECTION

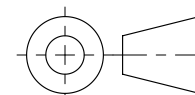

APPROVALS

DRAWN: NDA	DRAWN DATE: 11/30/2018
CHECKED:	CHECKED DATE:
ENG:	DATE:
MFG:	DATE:
QA:	DATE:

TRYSTAR, INC.
2917 INDUSTRIAL DRIVE, FARIBAULT, MN 55021
(507) 333-3990 - (866) TRYSTAR - TRYSTAR.COM

TITLE:
SMALL 19 SERIES; WALL MOUNT; DIMENSIONS & CONDUIT ENTRY AREA

SIZE C	CAGE CODE 1N5J6	DWG. NO. Sm19 xXX-aavW-xx(x)	REV -01
SCALE: 1:10		WEIGHT:	SHEET 1 OF 1