

Save time piecing together your project with pre-packaged lug cable connector kit.
Each kit is packaged to include 5 Mechanical lugs and hardware.

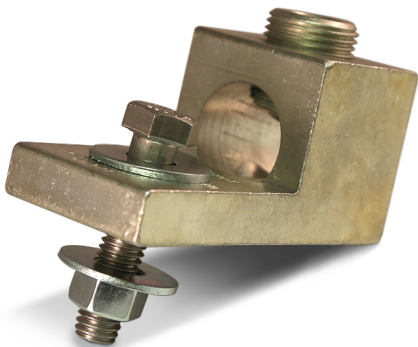

5X

PER PACKAGE:

Mechanical Lugs, Hex Bolts, Hex Nuts,
Fender Washers, and Lock Washers

Part Number	Description
TBQC-LUGKT-001*	Mechanical Lug Kit 2 AWG – 600 Kcmil, 3/16” Stainless Steel Hardware, 5 lug assemblies per pkg.

*This product is meant for Powertron® Tap Boxes that utilize a bus bar connection.

Specifications	
A	Cable Entry Point: 2 AWG – 600 Kcmil
B	3/8 Stud, Torque: 500
C	Thru Hole: 0.44” dia
D	Material: Solid Aluminum, Tin Plated

Shipping Weight: XXXlbs.

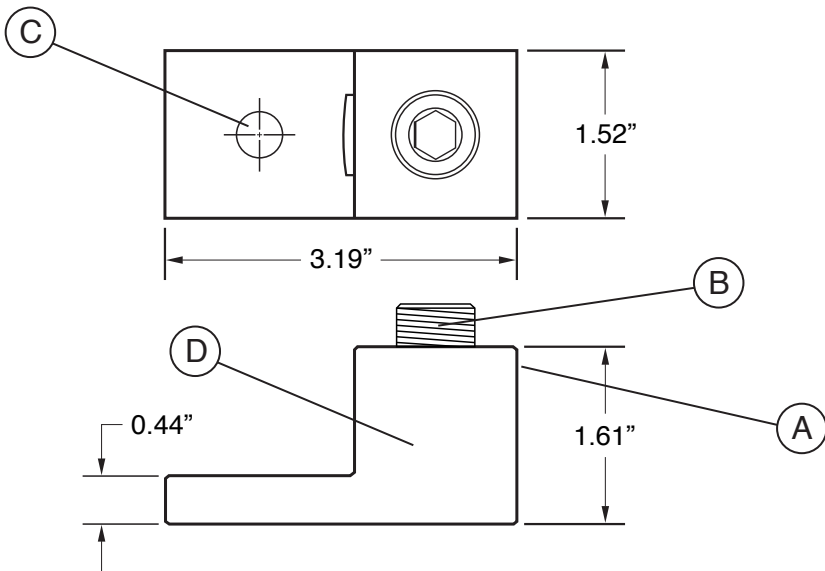

POWERTRON® Tap Box Warranty and Terms and Conditions of Sale
are available upon request or at www.powertronsolutions.com